



The LS853LED is a full featured shallow depth inground luminaire. The LED luminaire features a built in driver, and measures only 180 mm deep (in direct burial format). The ability to aim the luminaire ensures the most efficient light delivery can be set according to the site conditions.

## SPECIFICATIONS

<b>LED Source</b>	LED 14 W or 20 W <sup>(1)</sup> <i>Integral driver</i> <input type="checkbox"/> White (4300 K typical) <input type="checkbox"/> Warm white (3000 K typical) <input type="checkbox"/> Blue (470 nm) LED 20 W <sup>(1)</sup> <input type="checkbox"/> RGB
<b>IP Rating</b>	IP68
<b>Construction</b>	316 marine grade stainless steel
<b>Installation Types</b>	Direct burial <i>Landscapes, etc.</i>  Mounting collar <i>Decks and grates</i> (LS640)  Pre-installation blackout <i>Drive-over or other applications requiring pre-installation</i> (LS6072-K - with single gland entry) (LS6052-K - single colour line voltage with IP68 connector) (LS6102-K - single colour low voltage with IP68 connector)
<b>Drive-over</b>	With <b>OptiClear™</b> lens and pre-installation blackout
<b>Static Load Rating</b>	4200 kg with <b>OptiClear™</b> lens and pre-installation blackout
<b>Impact Rating</b>	IK10 with <b>OptiClear™</b> lens
<b>Standard Inclusions</b>	Teflon coated cover screws <b>MicroAntiLeach™</b> cable entry Thermal cutout Humidity absorbent desiccant
<b>Ambient Operating Temperature</b>	-20 °C to +50 °C
<b>Warranty</b>	10 year structural, 1 year electrical
<b>Accessories</b> <i>Order separately</i>	Refer to page 3 for direct burial Refer to page 5 for pre-installation
<b>Photometrics</b>	Go to <a href="http://www.lumascape.com.au">www.lumascape.com.au</a> ▶ Technical Data ▶ Photometric Files
<b>Glass Temperature</b>	<b>HumanTouch™</b> compliant ≤65 °C

NOTE: Product specifications are subject to change without notice. Any luminaire can become hot - take care with appropriate use and placement

<sup>(1)</sup> Nominal power consumption only, actual power consumed may vary.



LS853LED Recessed Cover



LS853LED Round Flush Cover



LS853LED Pre-installation Round Flush Cover

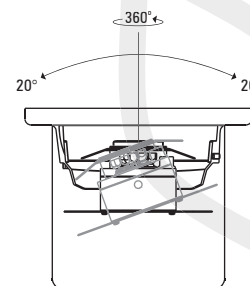

WHY USE DIRECT BURIAL

Direct burial installation is ideal for landscaping areas or in locations where the depth is restricted. This type of installation also allows for maximum heat dissipation. The stainless steel construction of the luminaire performs flawlessly in alkaline and acidic soil types, as well as chemically fertilised landscapes.

Cable Entry Option for Direct Burial

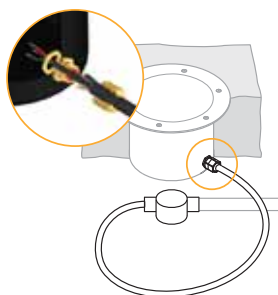

Armoured Cable & Junction Box

Armoured cable 0.6 m provides protection against damage to cable between luminaire and 3 way junction box (included). Allows for loop in/loop out and flexibility of luminaire placement.

*Not available for RGB option*

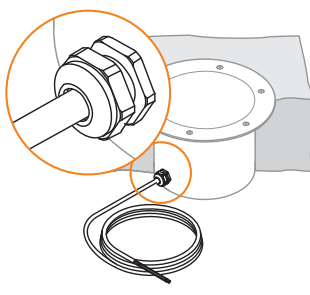

Single Gland Entry

MicroAntiLeach™ and 3 m flexible cable provide additional protection to luminaire against water ingress via cable.

Lens Options

**OptiClear™ Glass**  
Glass of very high optical purity and load strength. Suitable for drive-over applications.

**GripGlass™**  
OptiClear™ glass with slip reduction glazing process. Suitable for drive-over applications.

**Borosilicate Glass**  
Ideal for general use areas. Not suitable for drive-over applications.

Cover Options for Direct Burial



Recessed Cover

- SS316: Polished
- SS316: Brushed

Use recessed cover for installation in soil, grass, pavers and other uneven surfaces where no cover overhang is desired.

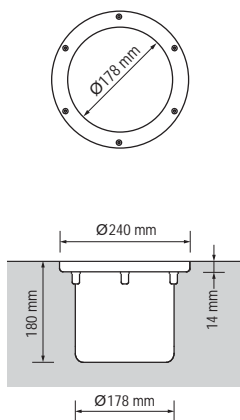

Round Flush Cover

- SS316: Polished
- SS316: Brushed

Use flush covers for installation in fine finished surfaces such as granite and marble. They can also be used in some suspended applications (decks, etc). The flush cover will conceal gaps between the luminaire and the surrounding surface.

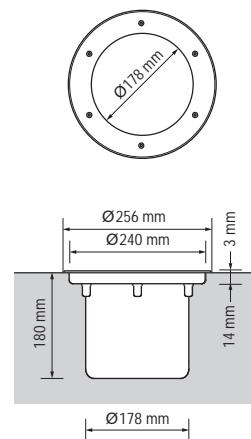

CONFIGURE THIS PRODUCT >

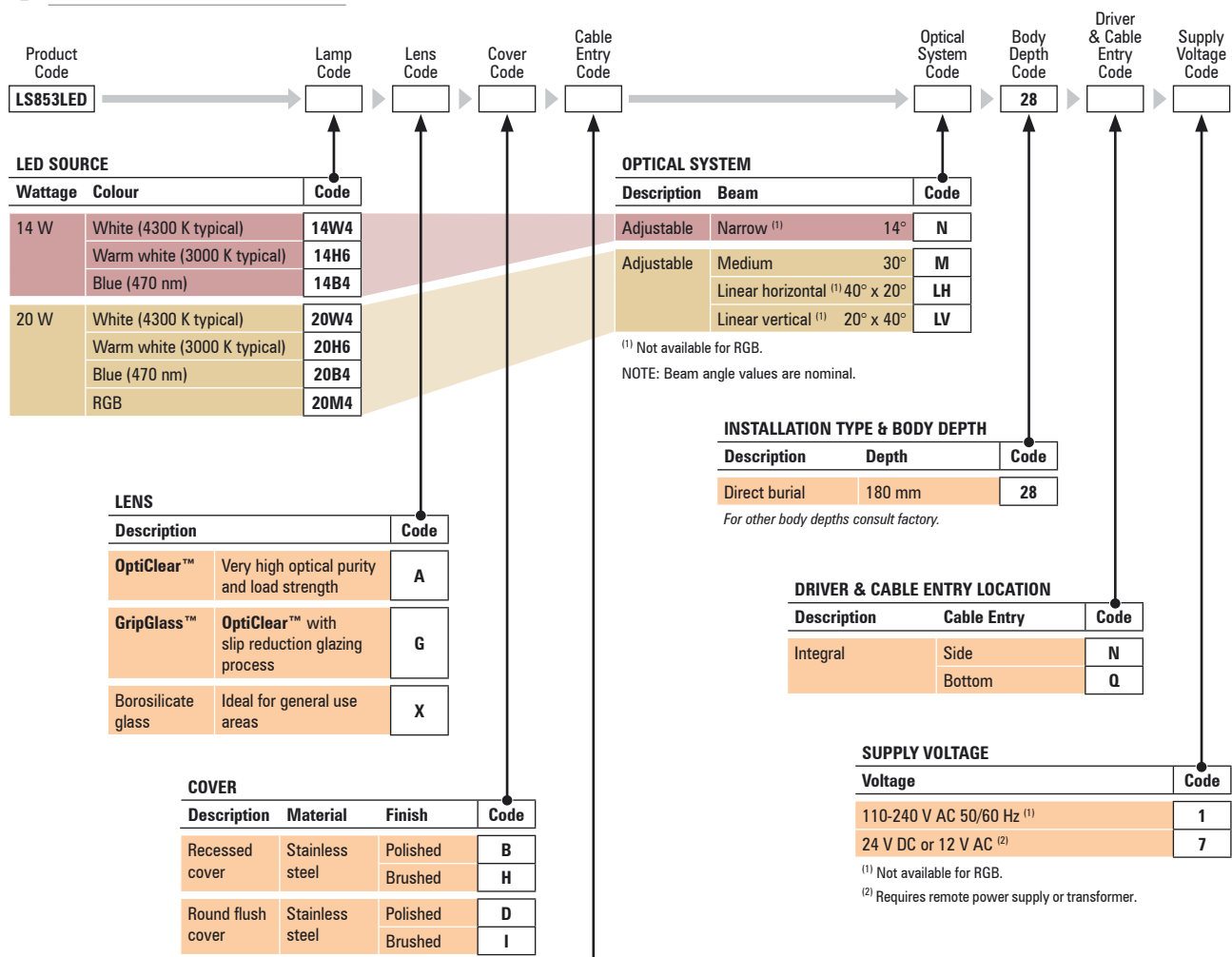

ACCESSORIES

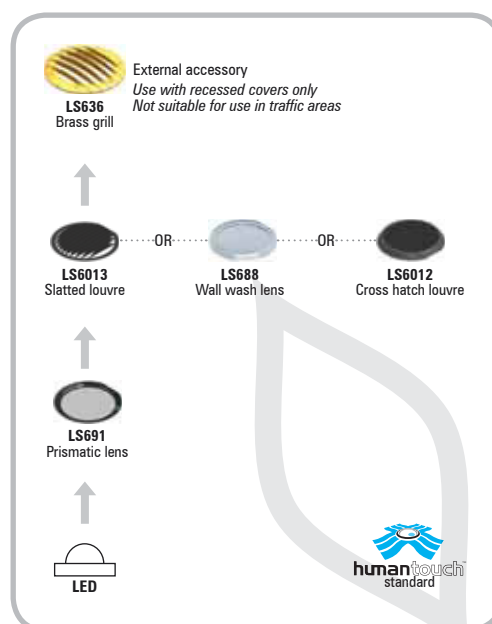

Other accessory stacking options may be available - consult factory

**WHY USE PRE-INSTALLATION BLOCKOUT**

This type of installation requires the LS6052-K, LS6072-K or LS6102-K pre-installation kit (order separately) which acts as a blockout, and is intended for installation before the luminaire. This method ensures the luminaire itself is not damaged during concreting or other site works, and also allows for all wiring to be completed prior to luminaire placement. Pre-installation also allows for off-site maintenance, via the detachable

IP68 connector fitted on the luminaire housing (LS6072-K uses a single gland entry instead).

The mating connector on the cable has a sealing cap which ensures water does not enter the cable before the installation is completed. Pre-installation is required for all drive-over applications.

**WHY USE MOUNTING COLLARS**

The LS640 mounting collar supports installation in decks and grates. They may also be used in hollow floors where there is appropriate ventilation.

**Cable Entry Option for Pre-Installation Blockout**

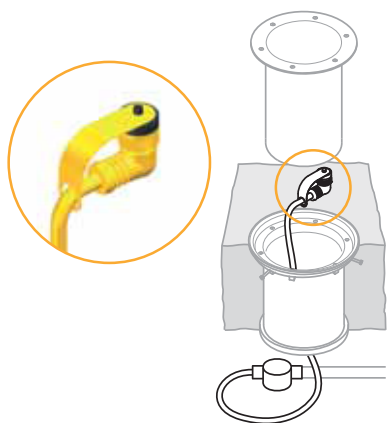

**IP68 Connector & Junction Box**

The luminaire is fitted with an IP68 connector, which attaches directly to the cable supplied with LS6052-K or LS6102-K without the use of any tools. The cable is 0.56 m in length, and is factory assembled with a 3 way junction box.

The LS640 mounting collar and the LS6072-K pre-installation kit have a single gland entry. See page 2.

**Lens Options**

**OptiClear™ Glass**



Glass of very high optical purity and load strength. Suitable for drive-over applications.

**GripGlass™**

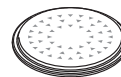

OptiClear™ glass with slip reduction glazing process. Suitable for drive-over applications.

**Borosilicate Glass**



Ideal for general use areas. Not suitable for drive-over application.

**Cover Options for Pre-Installation Blockout & Mounting Collar**

**Round Flush Cover**

- SS316: Polished
- SS316: Brushed



Flush covers for pre-installation use special seals and support bushes to ensure static loads up to 4200 kg are properly supported. In order to achieve this drive-over rating, OptiClear™ or GripGlass™ must be used.

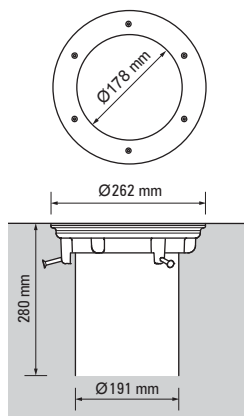

LS6052-K pre-installation blockout

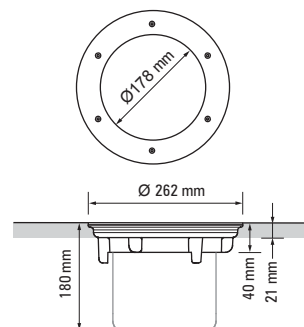

LS640 mounting collar

CONFIGURE THIS PRODUCT >

Product Code: **LS853LED**

Lamp Code: [ ] Lens Code: [ ] Cover Code: [ ] Cable Entry Code: [ ] Optical System Code: [ ] Body Depth Code: **29** Driver & Cable Entry Code: **Q** Supply Voltage Code: [ ]

LED SOURCE		
Wattage	Colour	Code
14 W	White (4300 K typical)	14W4
	Warm white (3000 K typical)	14H6
	Blue (470 nm)	14B4
20 W	White (4300 K typical)	20W4
	Warm white (3000 K typical)	20H6
	Blue (470 nm)	20B4
	RGB	20M4

OPTICAL SYSTEM		
Description	Beam	Code
Adjustable	Narrow <sup>(1)</sup>	14° N
	Medium	30° M
Adjustable	Linear horizontal <sup>(1)</sup> 40° x 20°	LH
	Linear vertical <sup>(1)</sup> 20° x 40°	LV

<sup>(1)</sup> Not available for RGB.  
NOTE: Beam angle values are nominal.

INSTALLATION TYPE & BODY DEPTH		
Description	Depth	Code
Mounting collar <sup>(1)</sup>	180 mm	29
Pre-installation <sup>(2)</sup>	280 mm	

<sup>(1)</sup> Requires LS640 - order separately.  
<sup>(2)</sup> Requires pre-installation kit - order separately.  
LS6072-K with single gland entry,  
LS6052-K with IP68 connector for single colour line voltage (code 1),  
LS6102-K with IP68 connector for single colour low voltage (code 7).  
For other body depths consult factory.

LENS		
Description		Code
<b>OptiClear™</b>	Very high optical purity and load strength	A
<b>GripGlass™</b>	OptiClear™ with slip reduction glazing process	G
Borosilicate glass <sup>(1)</sup>	Ideal for general use areas	X

<sup>(1)</sup> Not suitable for drive-over.

COVER			
Description	Material	Finish	Code
Round flush cover	Stainless steel	Polished	M
		Brushed	N

CABLE ENTRY	
Description	Code
Single gland entry, <b>MicroAntiLeach™</b> <sup>(1)</sup>	84
IP68 connector & J-box <sup>(2)</sup>	85

<sup>(1)</sup> Mounting collar or pre-installation blockout LS6072-K only.  
<sup>(2)</sup> Pre-installation blockout LS6102-K or LS6052-K only.  
Not available for RGB.

DRIVER & CABLE ENTRY LOCATION		
Description	Cable Entry	Code
Integral	Bottom	Q

SUPPLY VOLTAGE	
Voltage	Code
110-240 V AC 50/60 Hz <sup>(1)</sup>	1
24 V DC or 12 V AC <sup>(2)</sup>	7

<sup>(1)</sup> Not available for RGB.  
<sup>(2)</sup> Requires remote power supply or transformer.

ACCESSORIES

External accessory  
Use with recessed covers only  
Not suitable for use in traffic areas

LS636 Brass grill

LS6013 Slatted louvre OR LS688 Wall wash lens OR LS6012 Cross hatch louvre

LS691 Prismatic lens

LED

human touch standard

Other accessory stacking options may be available - consult factory