



The LS393 is a compact inground option, utilising 12 V Halogen MR16 lamps up to 35 W or 6 W LED. **HumanTouch™** is an important feature of this series, allowing placement in accessible areas. Adjustability of the lamp ensures light can be delivered where it is required. This model is also available with an 6 W LED array and integrated power supply, making it ideal for applications where line voltage supply is required.

### SPECIFICATIONS

<b>Lamp Source</b>	Halogen MR16 IRC (GU5.3)	35 W max
<b>IP Rating</b>	IP68	
<b>Construction</b>	316 marine grade stainless steel	
<b>Installation Types</b>	Direct burial <i>Landscapes, etc.</i>  Mounting collar <i>Decks and grates (LS647)</i>  Pre-installation blackout <i>Drive-over or other applications requiring pre-installation (LS647-K)</i>	
<b>Drive-over</b>	With <b>OptiClear™</b> lens and pre-installation blackout (LS647-K)	
<b>Static Load Rating</b>	3750 kg with <b>OptiClear™</b> lens and pre-installation blackout (LS647-K)	
<b>Impact Rating</b>	IK9 with <b>OptiClear™</b> lens	
<b>Standard Inclusions</b>	Teflon coated cover screws <b>MicroAntiLeach™</b> cable entry Thermal cutout Internal glare control louvre Humidity absorbent desiccant	
<b>Ambient Operating Temperature</b>	-20 °C to 40 °C	
<b>Warranty</b>	10 year structural, 1 year electrical	
<b>Accessories</b> <i>Order separately</i>	Refer to page 3 for direct burial Refer to page 5 for pre-installation	
<b>Photometrics</b>	Go to <a href="http://www.lumascape.com.au">www.lumascape.com.au</a> ▶ Technical Data ▶ Photometric Files	
<b>Glass Temperature</b>	<b>HumanTouch™</b> compliant ≤65 °C	

NOTE: Product specifications are subject to change without notice. Any luminaire can become hot - take care with appropriate use and placement.



LS393 Recessed Flush Cover



LS393 Round Flush Cover



LS393 Pre-installation Round Flush Cover

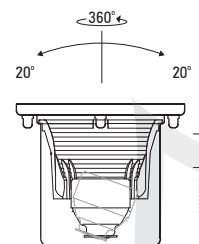

XK  
MR16 Reflector

WHY USE DIRECT BURIAL

Direct burial installation is ideal for landscaping areas or in locations where the depth is restricted. This type of installation also allows for maximum heat dissipation. The stainless steel construction of the luminaire performs flawlessly in alkaline and acidic soil types, as well as chemically fertilised landscapes.

Cable Entry Option for Direct Burial

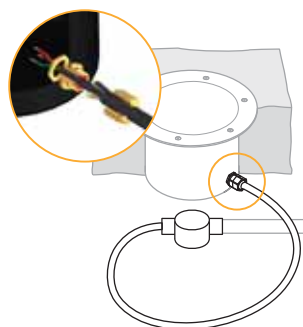

Armoured Cable MC & Junction Box

Armoured cable 0.6 m provides protection against damage to cable between luminaire and 3 way junction box (included). Allows for loop in/loop out and flexibility of luminaire placement.

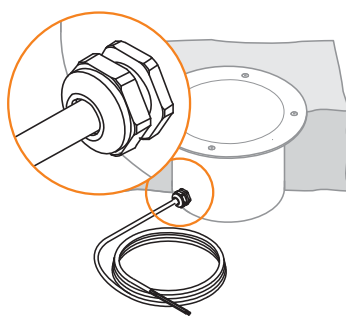

Single Gland Entry

MicroAntiLeach™ and 3 m flexible cable provide additional protection to luminaire against water ingress via cable.

Lens Options



OptiClear™ Glass

Glass of very high optical purity and load strength. Suitable for drive-over applications.

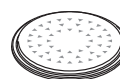

GripGlass™

OptiClear™ glass with slip reduction glazing process. Suitable for drive-over applications.



Borosilicate Glass

Ideal for general use areas. Not suitable for drive-over application.

Cover Options for Direct Burial



Recessed Cover

- SS316: Polished
- SS316: Brushed

Use recessed cover for installation in soil, grass, pavers and other uneven surfaces where no cover overhang is desired.

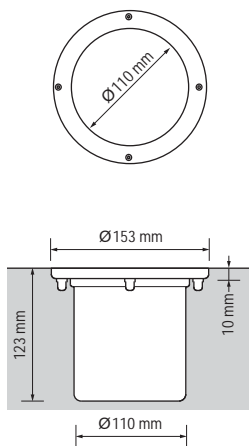

Round Flush Cover

- SS316: Polished
- SS316: Brushed

Use flush covers for installation in fine finished surfaces such as granite and marble. They can also be used in some suspended applications (decks, etc). The flush cover will conceal gaps between the luminaire and the surrounding surface.

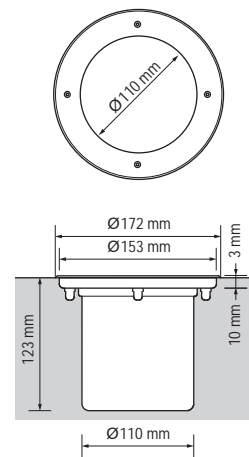

 CONFIGURE THIS PRODUCT >

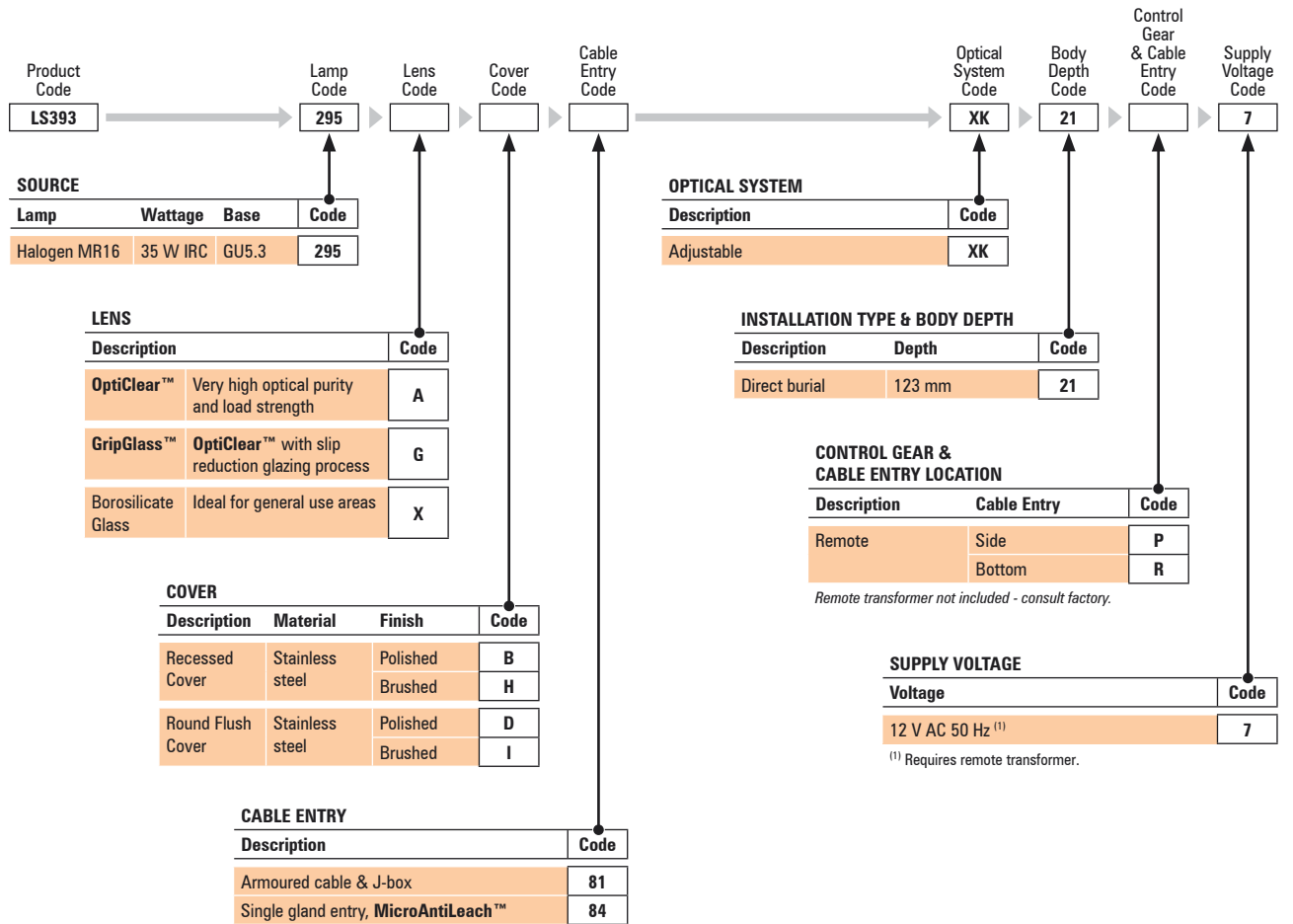

ACCESSORIES

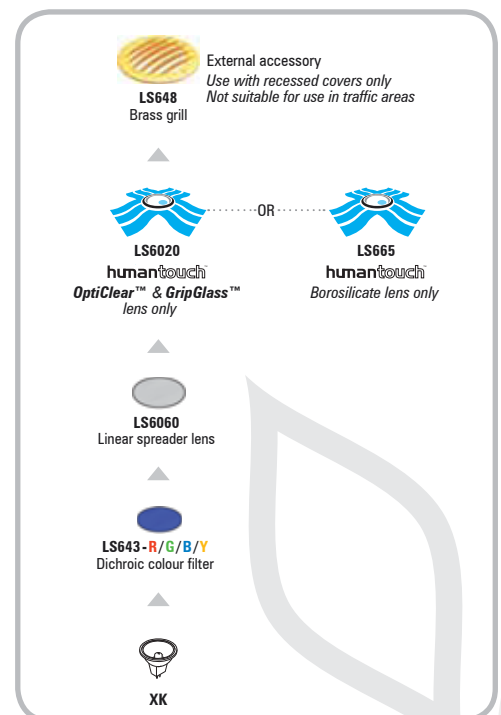

Other accessory stacking options may be available - consult factory

# LS393 Pre-Install & Mounting Collar Options

## WHY USE PRE-INSTALLATION BLOCKOUT

This type of installation requires the LS647-K pre-installation kit (order separately) which acts as a blockout, and is intended for installation before the luminaire. This method ensures the luminaire itself is not damaged during concreting or other site works, and also allows for all wiring to be completed prior to luminaire placement. Pre-installation also

allows for off-site maintenance, via the detachable IP68 connector fitted on the luminaire housing.

The mating connector on the cable has a sealing cap which ensures water does not enter the cable before the installation is completed. Pre-installation is required for all drive-over applications.

## WHY USE MOUNTING COLLARS

The LS647 mounting collar supports installation in decks and grates. They may also be used in hollow floors where there is appropriate ventilation.

### Cable Entry Option for Pre-Installation Blockout



#### IP68 Connector & Junction Box

The luminaire is fitted with an IP68 connector, which attaches directly to the cable supplied with LS647-K without the use of any tools. The cable is 0.56 m in length, and is factory assembled with a 3 way junction box.

LS647 mounting collars must use a single gland entry. See page 2.

### Lens Options

#### OptiClear™ Glass



Glass of very high optical purity and load strength. Suitable for drive-over applications.

#### GripGlass™

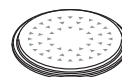

OptiClear™ glass with slip reduction glazing process. Suitable for drive-over applications.

#### Borosilicate Glass



Ideal for general use areas. Not suitable for drive-over application.

### Cover Options for Pre-Installation Blockout

#### Round Flush Cover

- SS316: Polished
- SS316: Brushed



Flush covers for pre-installation use special seals and support bushes to ensure static loads up to 4200 kg are properly supported. In order to achieve this drive-over rating, OptiClear™ or GripGlass™ must be used.

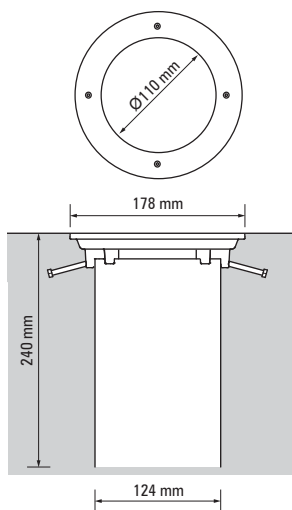

LS647-K pre-installation blockout

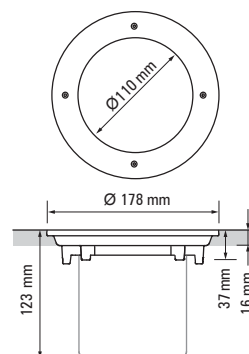

LS647 mounting collar

 CONFIGURE THIS PRODUCT >

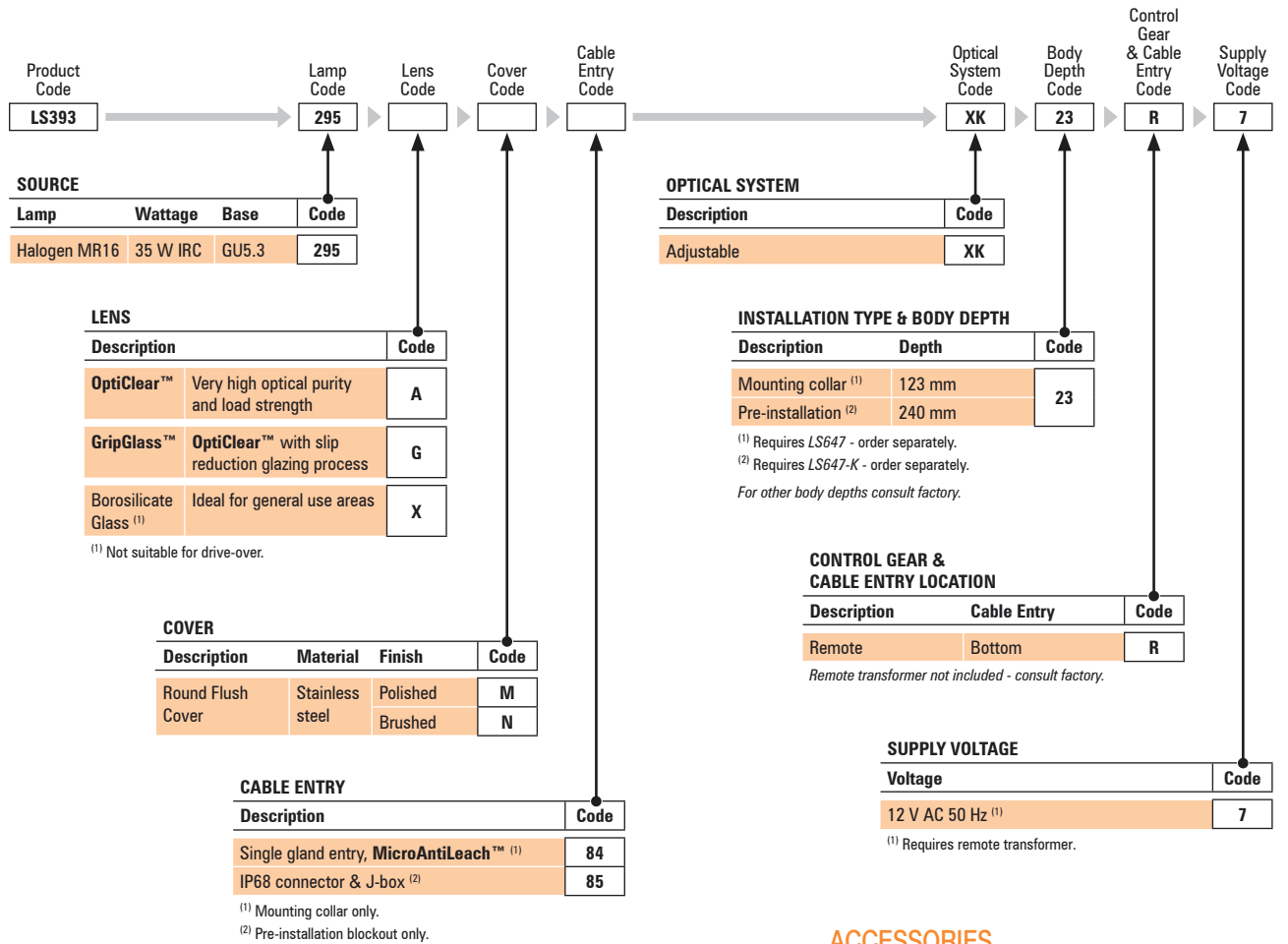

ACCESSORIES

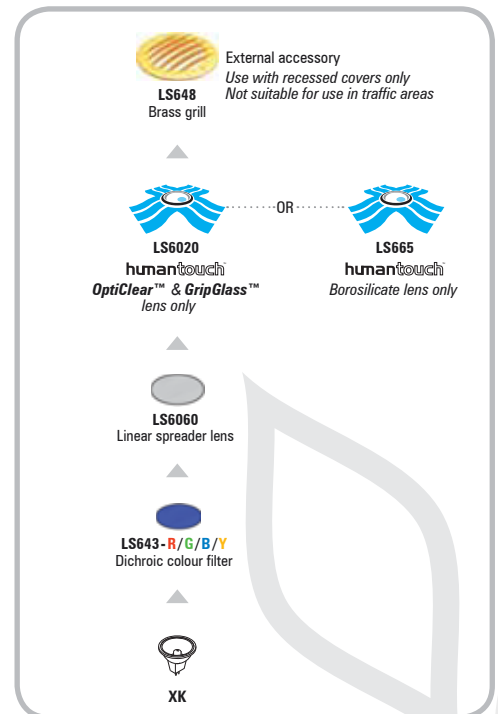

Other accessory stacking options may be available - consult factory