



The LS363 is an inground option now featuring 20 W metal halide technology. **HumanTouch™** is an important feature of this series, allowing placement in accessible areas. Adjustability of the reflector ensures light is delivered where it is required. The introduction of metal halide to this series now offers an attractive alternative to halogen in the same package size.

### SPECIFICATIONS

<b>Lamp Source</b>	MH / HIT T4 (PGJ5)	20 W
	Halogen MR16 (GU5.3)	50 W max
	CFL / TC-T (GX24q-2)	18 W
	INC PAR30/38 (E26 / E27 medium)	75 W max
<b>IP Rating</b>	IP68	
<b>Construction</b>	316 marine grade stainless steel	
<b>Installation Types</b>	Direct burial <i>Landscapes, etc.</i>	
	Mounting collar <i>Decks and grates</i> (LS644)	
	Pre-installation blackout <i>Drive-over or other applications requiring pre-installation</i> (LS644-K)	
<b>Drive-over</b>	With <b>OptiClear™</b> lens and pre-installation blackout (LS644-K)	
<b>Static Load Rating</b>	1800 kg with <b>OptiClear™</b> lens and pre-installation blackout (LS644-K)	
<b>Impact Rating</b>	IK9 with <b>OptiClear™</b> lens	
<b>Standard Inclusions</b>	Teflon coated cover screws	
	<b>MicroAntiLeach™</b> cable entry	
	Thermal cutout	
	Humidity absorbent desiccant	
<b>Ambient Operating Temperature</b>	MH / HIT T4	-20 °C to 40 °C
	Halogen MR16	-20 °C to 40 °C
	INC PAR30/38	-20 °C to 40 °C
	CFL / TC-T	0 °C to 40 °C
<b>Warranty</b>	10 year structural, 1 year electrical	
<b>Accessories</b> <i>Order separately</i>	Refer to pages 6-7	
<b>Photometrics</b>	Go to <a href="http://www.lumascape.com.au">www.lumascape.com.au</a> ▶ Technical Data ▶ Photometric Files	
<b>Glass Temperature</b>	<b>HumanTouch™</b> compliant models ≤65 °C	
	MH / HIT T4	20 W
	Halogen MR16	50 W max
	CFL / TC-T	18 W

NOTE: Product specifications are subject to change without notice. Any luminaire can become hot - take care with appropriate use and placement.



**LS363 Recessed Cover**  
Halogen lamp with MR16 reflector



**LS363 Round Flush Cover**  
Metal halide lamp with aluminium reflector



**LS363 Pre-installation Round Flush Cover**  
Metal halide lamp with aluminium reflector

WHY USE DIRECT BURIAL

Direct burial installation is ideal for landscaping areas or in locations where the depth is restricted. This type of installation also allows for maximum heat dissipation. The stainless steel construction of the luminaire performs flawlessly in alkaline and acidic soil types, as well as chemically fertilised landscapes.

Cable Entry Option for Direct Burial

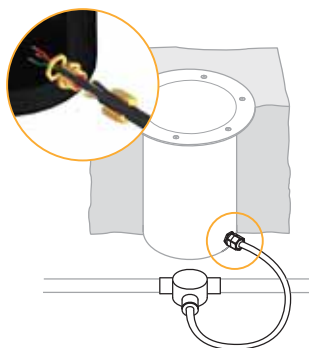

Armoured Cable & Junction Box

Armoured cable 0.6 m provides protection against damage to cable between luminaire and 3 way junction box (included). Allows for loop in/loop out and flexibility of luminaire placement.

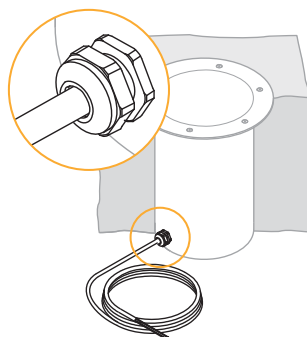

Single Gland Entry

MicroAntiLeach™ and 3 m flexible cable provide additional protection to luminaire against water ingress via cable.

Lens Options



OptiClear™ Glass

Glass of very high optical purity and load strength. Suitable for drive-over applications.

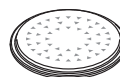

GripGlass™

OptiClear™ glass with slip reduction glazing process. Suitable for drive-over applications.



Borosilicate Glass

Ideal for general use areas. Not suitable for drive-over application.

Cover Options for Direct Burial



Recessed Cover

- SS316: Polished
- SS316: Brushed

Use recessed cover for installation in soil, grass, pavers and other uneven surfaces where no cover overhang is desired.

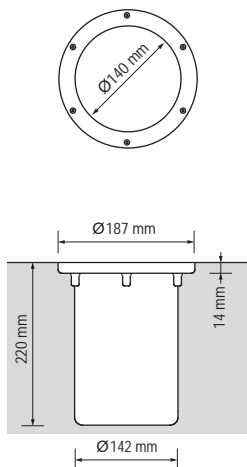

Round Flush Cover

- SS316: Polished
- SS316: Brushed

Use flush covers for installation in fine finished surfaces such as granite and marble. They can also be used in some suspended applications (decks, etc). The flush cover will conceal gaps between the luminaire and the surrounding surface.

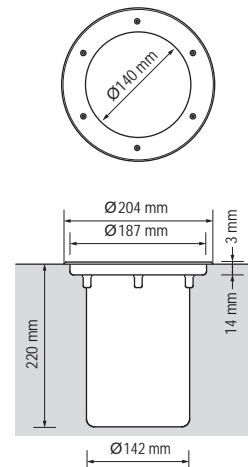

 CONFIGURE THIS PRODUCT >

Product Code: **LS363**

Lamp Code: [ ] Lens Code: [ ] Cover Code: [ ] Cable Entry Code: [ ] Optical System Code: [ ] Body Depth Code: **21** Control Gear & Cable Entry Code: [ ] Supply Voltage Code: [ ]

**SOURCE**

Lamp	Wattage	Base	Code
MH / HIT T4 ECG <sup>(1)</sup>	20 W	PGJ5	227
INC PAR30/38	75 W max	E26 / E27 medium	252
CFL / TC-TEL ECG <sup>(1)</sup>	18 W	GX24q-2	266
Halogen MR16	50 W max	GU5.3	292

<sup>(1)</sup> ECG - Electronic Control Gear.

**LENS**

Description	Code
OptiClear™ Very high optical purity and load strength	A
GripGlass™ OptiClear™ with slip reduction glazing process	G
Borosilicate glass Ideal for general use areas	X

**COVER**

Description	Material	Finish	Code
Recessed cover	Stainless steel	Polished	B
		Brushed	H
Round flush cover	Stainless steel	Polished	D
		Brushed	I

**CABLE ENTRY**

Description	Code
Armoured cable and J-box	81
Single gland entry, MicroAntiLeach™	84

**OPTICAL SYSTEM**

Description	Reflector	Beam	Code
Adjustable	Aluminium	Narrow 10°	XV <b>1</b>
		Medium 30°	XW <b>1</b>
		Flood 55°	XX <b>1</b>
		Wide flood 75°	XY <b>1</b>
Adjustable	PAR30/38		XS <b>4</b>
Fixed	Aluminium	Flood 140°	XL <b>3</b>
Adjustable	MR16		XK <b>2</b>

**1** These numbers refer to the compatible accessories tables on pages 6-7.

**2**

**3**

**4**

**INSTALLATION TYPE & BODY DEPTH**

Description	Depth	Code
Direct burial	220 mm	21

*For other body depths consult factory.*

**CONTROL GEAR & CABLE ENTRY LOCATION**

Description	Cable Entry	Code
Integral	Side	N
	Bottom	Q
Remote	Side	P
	Bottom	R

*Remote control gear not included - consult factory.*

**SUPPLY VOLTAGE**

Voltage	Code
220-240 V 50/60 Hz	1
12 V AC 50 Hz <sup>(1)</sup>	7

<sup>(1)</sup> Halogen MR16 only (code 292). Requires remote transformer.

# LS363 Pre-Install & Mounting Collar Options

## WHY USE PRE-INSTALLATION BLOCKOUT

This type of installation requires the LS644-K pre-installation kit (order separately) which acts as a blockout, and is intended for installation before the luminaire. This method ensures the luminaire itself is not damaged during concreting or other site works, and also allows for all wiring to be completed prior to luminaire placement. Pre-installation also

allows for off-site maintenance, via the detachable IP68 connector fitted on the luminaire housing.

The mating connector on the cable has a sealing cap which ensures water does not enter the cable before the installation is completed. Pre-installation is required for all drive-over applications.

## WHY USE MOUNTING COLLARS

The LS644 mounting collar supports installation in decks and grates. They may also be used in hollow floors where there is appropriate ventilation.

### Cable Entry Option for Pre-Installation Blockout

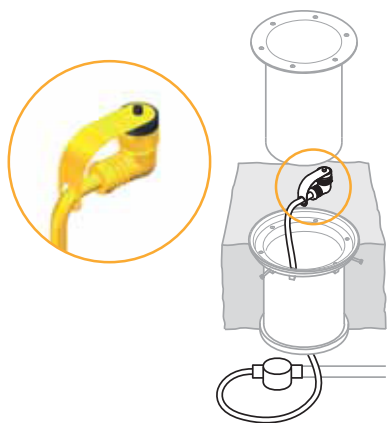

#### IP68 Connector & Junction Box

The luminaire is fitted with an IP68 connector, which attaches directly to the cable supplied with LS644-K, without the use of any tools. The cable is 0.56 m in length, and is factory assembled with a 3 way junction box.

LS644 mounting collars must use a single gland entry. See page 2.

### Lens Options

#### OptiClear™ Glass



Glass of very high optical purity and load strength. Suitable for drive-over applications.

#### GripGlass™

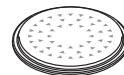

OptiClear™ glass with slip reduction glazing process. Suitable for drive-over applications.

#### Borosilicate Glass



Ideal for general use areas. Not suitable for drive-over application.

### Cover Options for Pre-Installation Blockout

#### Round Flush Cover

- SS316: Polished
- SS316: Brushed



Flush covers for pre-installation use special seals and support bushes to ensure static loads up to 1800 kg are properly supported. In order to achieve this drive-over rating, OptiClear™ or GripGlass™ must be used.

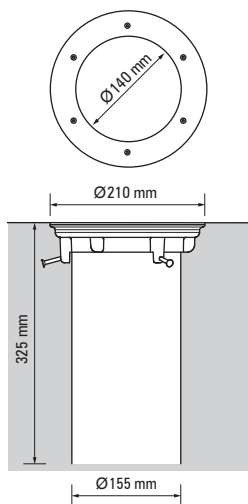

LS644-K pre-installation blockout

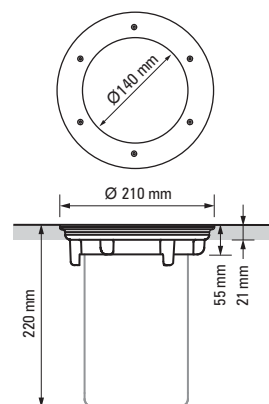

LS644 mounting collar

 **CONFIGURE THIS PRODUCT >**

Product Code

**LS363**

Lamp Code

**227**

Lens Code

**A**

Cover Code

**M**

Cable Entry Code

**84**

Optical System Code

**XV**

Body Depth Code

**23**

Control Gear & Cable Entry Code

**Q**

Supply Voltage Code

**1**

### SOURCE

Lamp	Wattage	Base	Code
MH / HIT T4 ECG <sup>(1)</sup>	20 W	PGJ5	227
INC PAR30/38	75 W max	E26 / E27 medium	252
CFL / TC-TEL ECG <sup>(1)</sup>	18 W	GX24q-2	266
Halogen MR16	50 W max	GU5.3	292

<sup>(1)</sup> ECG - Electronic Control Gear

### OPTICAL SYSTEM

Description	Reflector	Beam	Code
Adjustable	Aluminium	Narrow 10°	XV <b>1</b>
		Medium 30°	XW <b>1</b>
		Flood 55°	XX <b>1</b>
		Wide flood 75°	XY <b>1</b>
Adjustable	PAR30/38		XS <b>4</b>
Fixed	Aluminium	Flood 140°	XL <b>3</b>
Adjustable	MR16		XK <b>2</b>

### LENS

Description	Code
OptiClear™ Very high optical purity and load strength	A
GripGlass™ OptiClear™ with slip reduction glazing process	G
Borosilicate glass <sup>(1)</sup> Ideal for general use areas	X

<sup>(1)</sup> Not suitable for drive-over.

### COVER

Description	Material	Finish	Code
Round flush cover	Stainless steel	Polished	M
		Brushed	N

### CABLE ENTRY

Description	Code
Single gland entry, MicroAntiLeach™ <sup>(1)</sup>	84
IP68 connector & J-box <sup>(2)</sup>	85

<sup>(1)</sup> Mounting collar only.  
<sup>(2)</sup> Pre-installation blackout only.

### INSTALLATION TYPE & BODY DEPTH

Description	Depth	Code
Mounting collar <sup>(1)</sup>	220 mm	23
Pre-installation <sup>(2)</sup>	325 mm	

<sup>(1)</sup> Requires LS644 - order separately.  
<sup>(2)</sup> Requires LS644-K - order separately.  
For other body depths consult factory.

### CONTROL GEAR & CABLE ENTRY LOCATION

Description	Cable Entry	Code
Integral	Bottom	Q
Remote	Bottom	R

Remote control gear not included - consult factory.

### SUPPLY VOLTAGE

Voltage	Code
220-240 V 50/60 Hz	1
12 V AC 50 Hz <sup>(1)</sup>	7

<sup>(1)</sup> Halogen MR16 only (code 292). Requires remote transformer.

**1** These numbers refer to the compatible accessories tables on pages 6-7.

**2**

**3**

**4**

1

**MH / HIT**  
Adjustable Aluminium Reflector  
XV / XW / XX / XY

Stacking and order of accessories

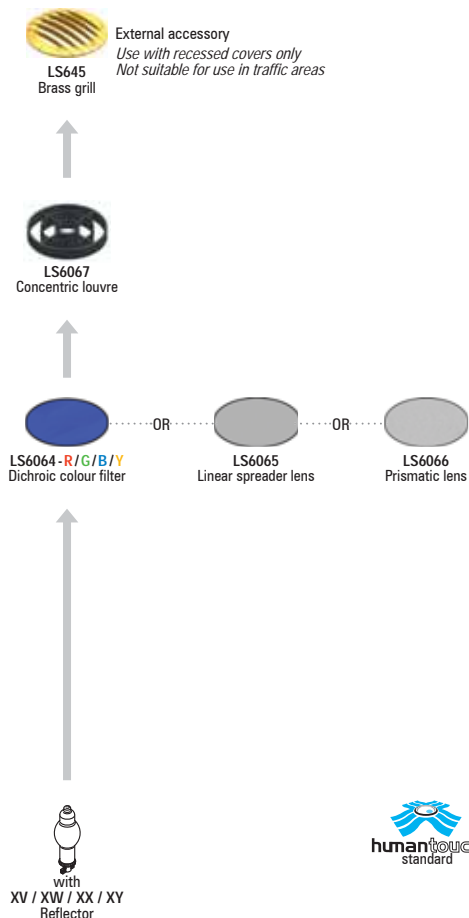

Other accessory stacking options may be available - consult factory

2

**Halogen MR16**  
Adjustable MR16 Gimbal  
XK

Stacking and order of accessories

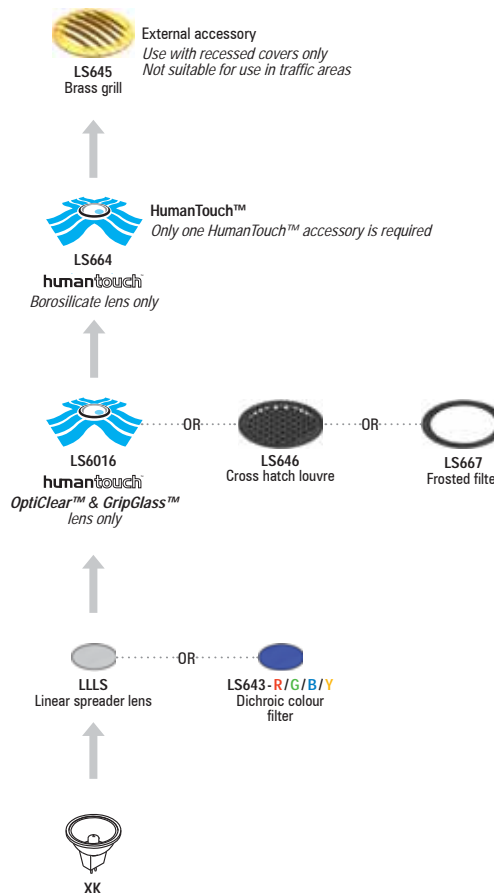

Other accessory stacking options may be available - consult factory

Cross section of gimbal assembly within luminaire body

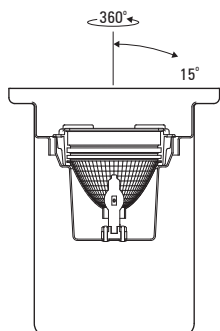

XV / XW / XX / XY  
Adjustable Aluminium  
Reflector

Cross section of gimbal assembly within luminaire body

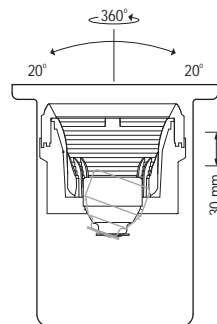

XK  
Adjustable MR16  
Gimbal

3

CFL / TC-T  
Fixed Aluminium Reflector  
XL

Stacking and order of accessories

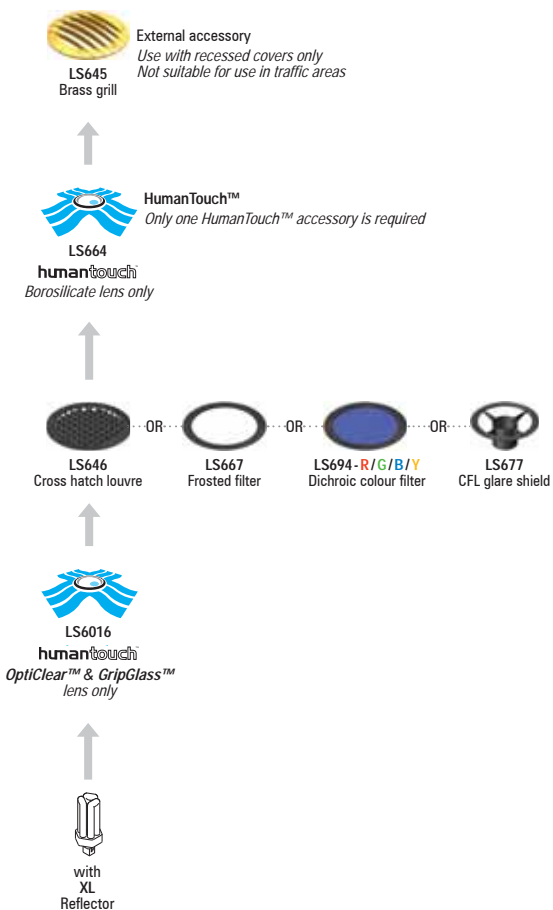

Other accessory stacking options may be available - consult factory

Cross section of gimbal assembly within luminaire body

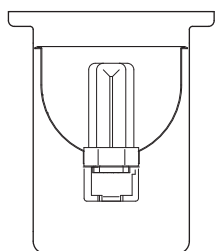

XL  
Fixed Aluminium  
Reflector

4

INC PAR30/38  
Fixed PAR Lamp  
XS

Stacking and order of accessories

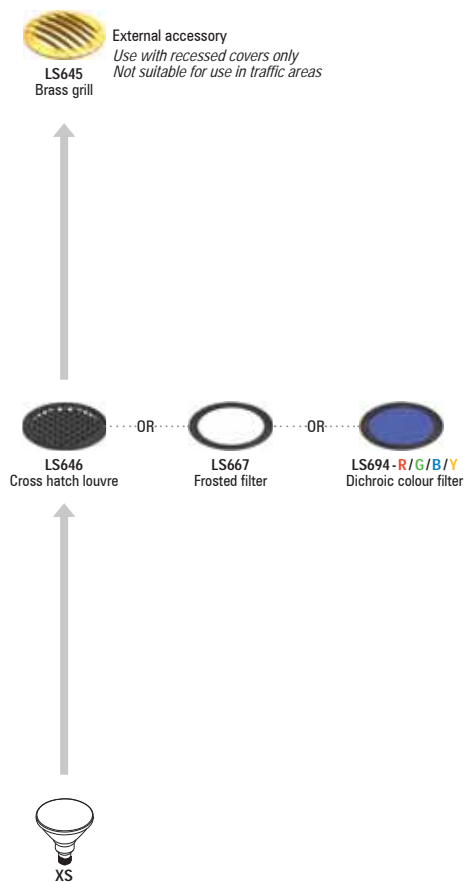

Other accessory stacking options may be available - consult factory

Cross section of gimbal assembly within luminaire body

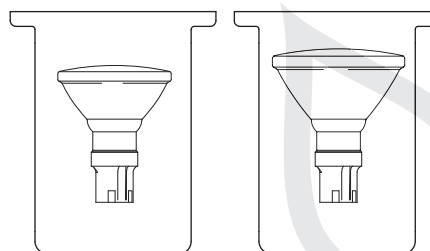

XS  
Fixed PAR30 Lamp

XS  
Fixed PAR38 Lamp